

**STRAIGHT PANEL JACK MOUNTING SOLDER TYPE
ON CABLE .085**

R199.005.023

Series : MC-CARD

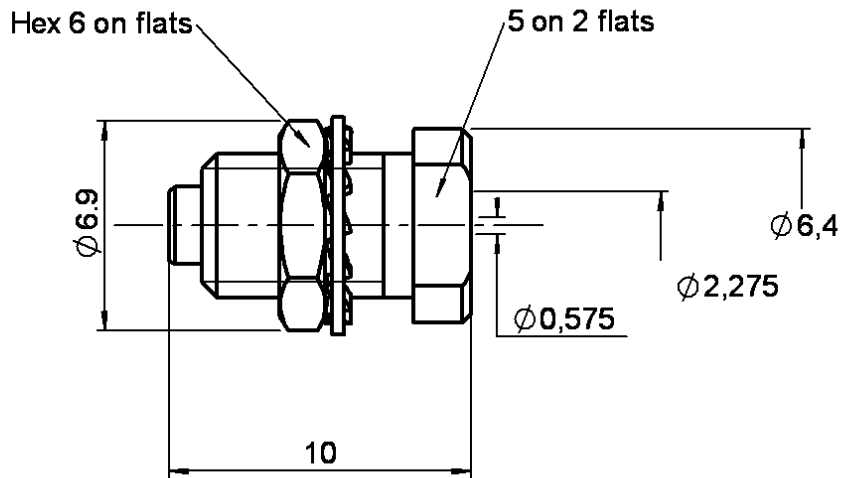

PANEL CUT OUT

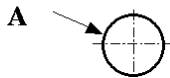

mm		
	Maxi	mini
A	4.85	4.8

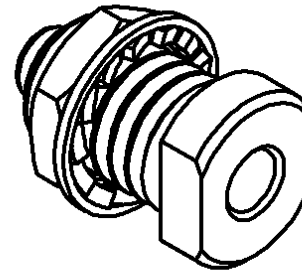
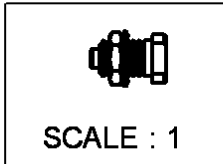

All dimensions are in mm.



COMPONENTS	MATERIALS	PLATINGS (µm)
BODY	BRASS	GOLD 0.5 OVER NICKEL 2
CENTER CONTACT	CuBe2	GOLD 1.3 OVER NICKEL 2
OUTER CONTACT	-	-
INSULATOR	PTFE	-
GASKET	-	-
OTHERS PARTS	BRASS	-
-	-	-
-	-	-

Issue : 0049 C

In the effort to improve our products, we reserve the right to make changes judged to be necessary.



**STRAIGHT PANEL JACK MOUNTING SOLDER TYPE
ON CABLE .085**

R199.005.023

Series : MC-CARD

PACKAGING

Standard	Unit	Other
100	'W' option	Contact us

SPECIFICATION

ELECTRICAL CHARACTERISTICS

Impedance		50 Ω
Frequency		0-8 GHz
VSWR	1.15 +	0.015 x F(GHz) Maxi
Insertion loss		.07 √F(GHz) dB Maxi
RF leakage	- (65 - F(GHz)) dB Maxi
Voltage rating		170 Veff Maxi
Dielectric withstanding voltage		500 Veff mini
Insulation resistance		5000 MΩ mini

CABLE ASSEMBLY

Stripping	a	b	c	d	e	f
mm	1.78	0.00	0.00	0.00	0.00	0.00

Assembly instruction :

Recommended cable(s)
KS 1
RG 405

MECHANICAL CHARACTERISTICS

Center contact retention		
Axial force – Mating end	NA	N mini
Axial force – Opposite end	NA	N mini
Torque	NA	N.cm mini

Cable retention

- pull off	136	N mini
- torque	NA	N.cm

TOOLING

Part Number	Description	Hexagon
.	.	.
R282.062.000	POINTER GAUGE	APPOINTE UR
R282.051.000	STRIPPING TOOL	DENUDEU R

Recommended torque		
Mating	NA	N.cm
Panel nut	60	N.cm
Clamp nut	NA	N.cm
A/F clamp nut	6.000	mm

Mating life	0	Cycles mini
Weight	1.555	g

OTHERS CHARACTERISTICS

ENVIRONMENTAL

Operating temperature	-65/+105	° C
Hermetic seal	NA	Atm.cm3/s
Panel leakage	NA	

Issue : 0049 C

In the effort to improve our products, we reserve the right to make changes judged to be necessary.



STRAIGHT PANEL JACK MOUNTING SOLDER TYPE
ON CABLE .085

R199.005.023

Series : MC-CARD

COMPONENTS

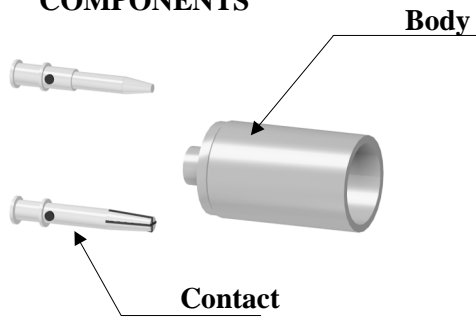

STRIPPING DIMENSIONS

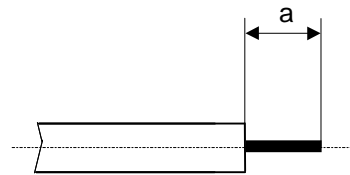

We recommend a cable thermal preconditioning before assembly.

1

Insert the cable into the clamp element.
 Present the pointer in front of the clamp element.
 Push the cable until it stops, while holding the clamp element pushed on the hollow part of the pointer.
 Turn the clamp element until the release of the pointer.

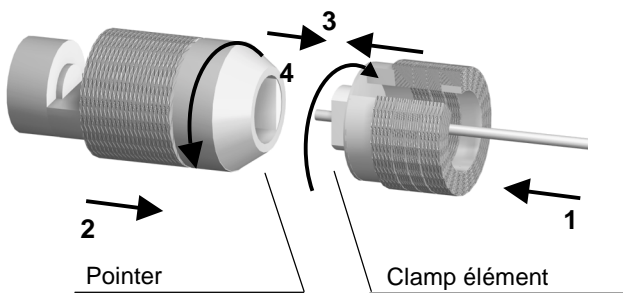

3

Solder the cable inner conductor into

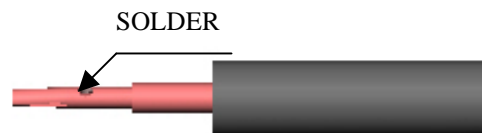

2

Present the cutting element in front of the clamp element.
 Push and turn both elements, back part opposite to the front part.
 Once they reach the stop, pull without revolving.

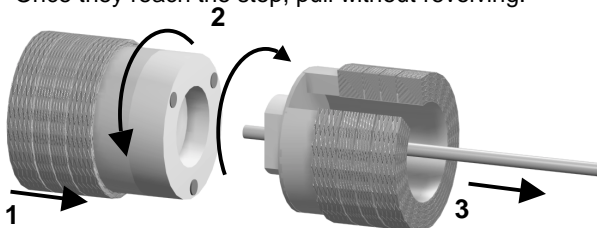

4

Slide sub-assembly into the connector body (in direction F)

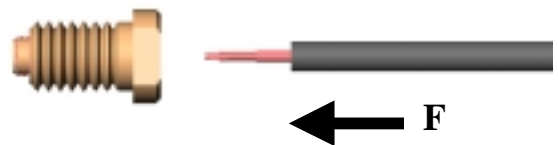

5

Solder the cable into body of connector.
 After cooling clean

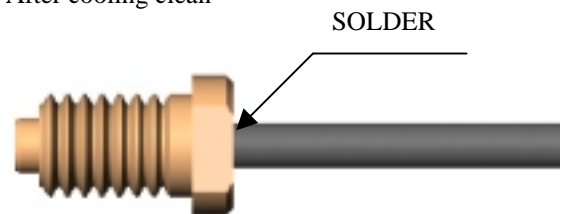

Issue : 0049 C

In the effort to improve our products, we reserve the right to make changes judged to be necessary.

